



AL3010



AL3020



AL3030

Technical Manual

AL3010 (Metal Housing-Chrome)

AL3020 (ABS* Housing-Chrome)

AL3030 (ABS* Housing-Black)

CHARACTERISTICS

The slightly angled keypad has an integrated battery compartment in the bottom of the Alpha entry unit and opens by moving a slider. Cable length is approximately 30 cm.

DIMENSIONS / MOUNTING INSTRUCTION

The diameter of the cable hole should be minimum 9 mm, maximum 12 mm. The hole must be de-burred well to avoid damage to the cable.

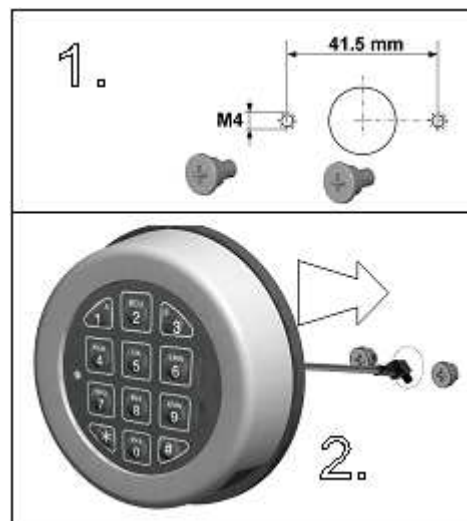

1. Affix the rotating plate with the two mounting adapter-screws (M4) hand tied.
2. Route the cable through the cable hole. Drill the screw heads so that tools don't work for dismounting (due to EN1300) and slide the unit on the mounting adapters in position 10:00 o'clock. Turn to 12:00 when fixing with pin.

The Alpha 2 entry unit can now not be removed!

Connect one (1) battery to the battery clip.

Only use new 9V ALKALINE Duracell/ Procell- or Energizer batteries.

This mounting instruction is part of VdS certification and has to be followed up precisely.

*Acrylonitrile butadiene styrene, or ABS, (chemical formula $(C_8H_8 \cdot C_4H_6 \cdot C_3H_3N)$) is a common thermoplastic used to make rigid, moulded products.