

MODULAR

Technical manual



ST2060



ST3060



ST3560

ST2060, ST3060, ST3560

CHARACTERISTICS

The protrusion of this dial assembly from the EuroLine “Modular” series is very low. ST3560 further reduces the protrusion as it is recessed and almost flush with the door surface. The dial is made from metal with a mat chrome finish. The plastic base unit is available in mat chrome (ST2060) or black (ST3060, ST3560). The dial is delivered with a 6mm square shaft as spindle and is for use with the ML6740 mechanical combination lock only.

PREPARATION

Measure the distance (D) between the mounting surfaces of the dial and the lock (see picture below). Cut the shaft in one of the eight provided grooves. Use the table below to determine in which groove to cut. Do not leave more segments on the shaft than necessary. Normally no de-burring is required.

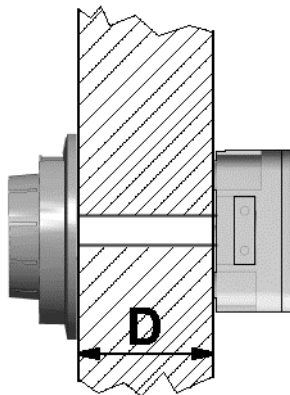

Distance (D) less than		Cut groove #
39 mm	1.5 inch	1
51 mm	2.0 inch	2
64 mm	2.5 inch	3
77 mm	3.0 inch	4
89 mm	3.5 inch	5
102 mm	4.0 inch	6
115 mm	4.5 inch	7
127 mm	5.0 inch	8

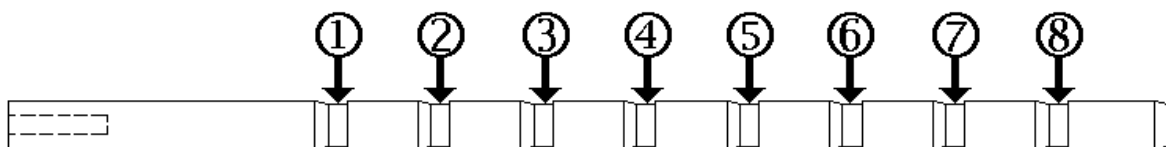

DIMENSIONS / INSTALLATION

ST2060 mat chrome, ST3060 black

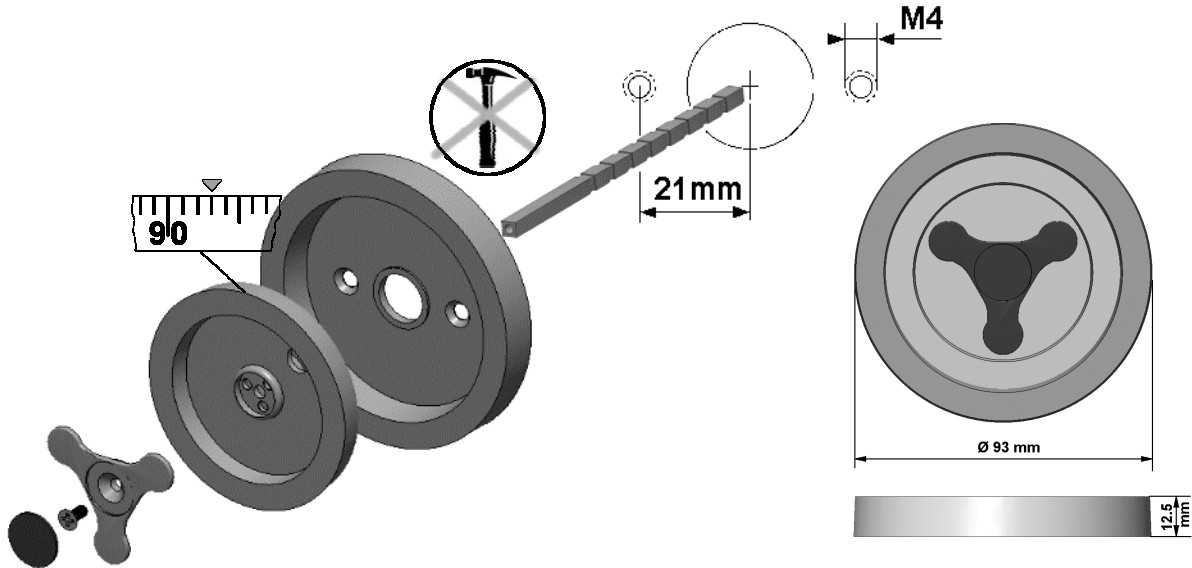

ST3560 flush, black

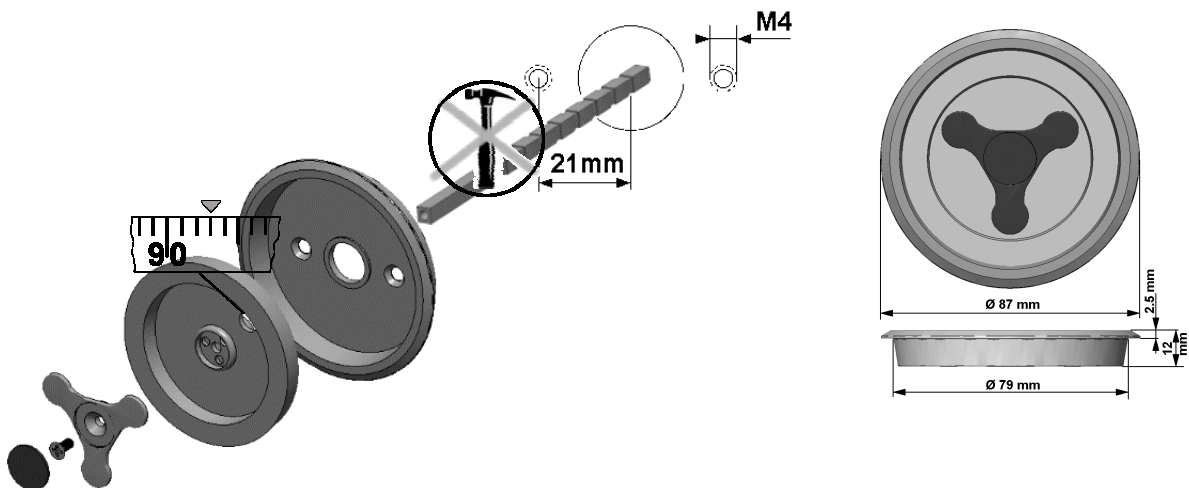

Affix the 6mm shaft with the provided screw in the dial and cover the screw with the small label.

Install the ML6740 lock first according to the installation instruction.

Fasten the dial ring with two M4 or 8/32" countersunk screws (not included) in a way that the opening index is positioned at the 12 o'clock position.

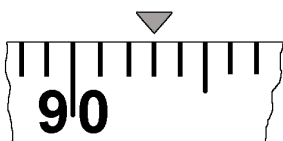

With the lock in OPEN position (bolt retracted) hold the dial in a way that approximately "93" is lined up with the opening index and push it into the lock.

The shaft cannot be pulled out.